

# OWG100-CPR430-G-2.125GHz

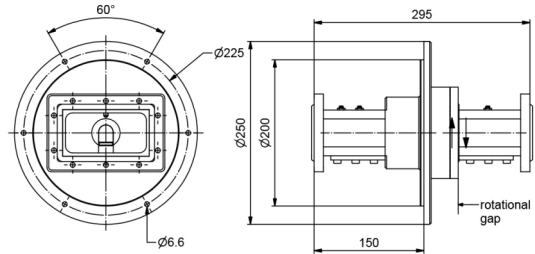

## RF channel characteristics

Interfaces	CPR 430 / G
Style	I
Frequency range	2.025-2.125 GHz
Peak power , max	100 KW
Average power . max	5 KW
VSWR . max	1.1
VSWR WOW . max	0.04
Insertion loss . max	0.15 dB
Insertion loss WOW . max	0.02 dB
Phase WOW . max	2 deg

## General mechanical data

Differential operating pressure, nom	0.5 x 10 <sup>5</sup> Pa ( 0 . 5 bar)
Leakage rate, max	3 cm <sup>3</sup> / minute
Rotating speed, max	60 rpm
Life. min	10 x 10 <sup>6</sup> revolutions
Starting torque, max	2 Nm@room temperature
Torque during rotation, max	2 Nm@room temperature
Case material	copper alloy
Case surface finish	painted dark grey ( RAL 7021)
Weight, approx	14.7 Kg

## General environmental conditions Operation

---

Ambient temperature range	-40°C~ +55°C
Relative humidity , max	95%
IP protection level	IP65